

Date of issue: 26<sup>th</sup> February 2014

**Change Notification Number: 1228**

**Change Title: Product range update**

**Affected Products:**

UL94-V2 material:

CTSN435/12, CTSN435/12W, CTSN435/12R, CTSN435/12WR

UL94-V0 material:

CTSN535/12, CTSN535/12W, CTSN535/12R, CTSN535/12WR

UL94-V0 GF material:

CTSN635/12, CTSN635/12W, CTSN635/12R, CTSN635/12WR

(and smaller pole sizes derived from these)

**Description:**

Due to a tooling upgrade the above mentioned products will feature:

1. Guided wire entries - moulding fits the shape of the metal inserts preventing wires from straying outside the inserts.



2. Flexible fixing holes – gives greater adaptability to different fixing methods

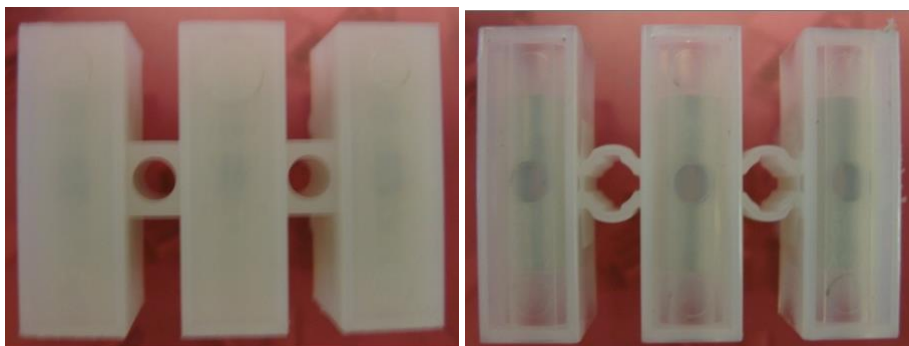

3. A higher purity polyamide will be used. This has a more transparent look and will result in no sharp edges

#### 4. Dimensional changes:

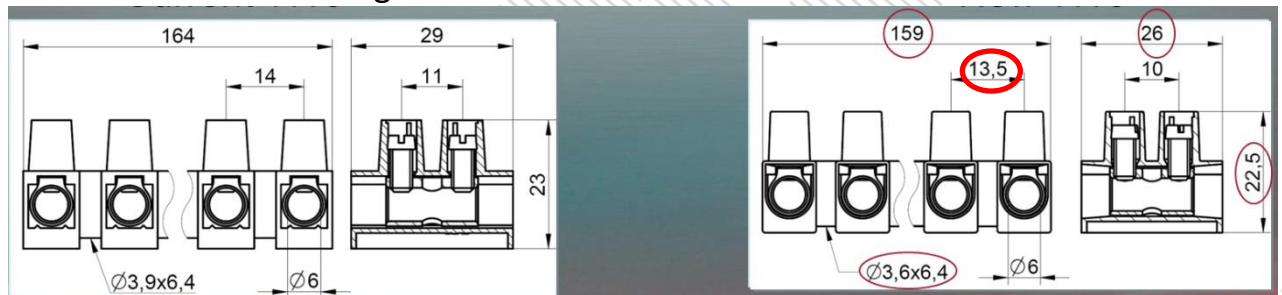

5. CTSN635 only – maximum temperature is to be reduced from 180°C to 160°C

**Due to the change in pitch, a new part number will be issued:**

**CTSN436/12 (UL94-V2)**

**CTSN536/12 (UL94-V0)**

**CTSN636/12 (UL94-V0 GF)**

CTSN435, CTSN535, CTSN635 will be discontinued once stock is exhausted.





Please refer to the attached latest datasheet for full details.

For questions or concerns regarding this notification, please contact:

[michael.bridge@camdenboss.com](mailto:michael.bridge@camdenboss.com)

# INTERCONNECTION

## 12 Way Nylon Terminal Strips

- Moulded from Natural PA6 (standard, CTSN400), Cream PA66 (CTSN500,) Grey PA66 Glass fibre (CTSN600)
- Available with or without wire protection
- UL94-V2 Self extinguishing as standard
- V0 types pass 960°C glow-wire test
- Easily cut to size
- Can also be supplied pre-cut
- Can be printed on request
- Closed inserts (middle barrier) option
- Captive terminal screws
-     approvals



### SPECIFICATION

Voltage	CTSN431-433	450VAC
	CTSN434-438	750VAC (UL600VAC)
Working temperature	CTSN400	-30°C to +110°C
	CTSN500	-30°C to +110°C
	CTSN600	-5°C to +160°C
Moulding	CTSN400	UL94-V2 PA6
	CTSN500	UL94-V0 PA66
	CTSN600	UL94-V0 PA66 + GF
Standard insert	Nickel-plated brass	
Terminal screws	Zinc-plated steel CQ-15	
Wire protectors	Stainless steel	

Part Numbers shown are for standard PA6 material (e.g. CTSN433/12)

For CTSN500 PA66 material change first number to 5 (e.g. CTSN533/12)

For CTSN600 PA66+GF material change first number to 6 (e.g. CTSN633/12)

### Standard Type

TYPE NO.	PITCH / UL RATING	WIRE PROTECTION	INSERT DIAMETER	CABLE ACCEPTANCE	TERMINAL SCREWS	LENGTH	WIDTH	HEIGHT	PITCH	FIXING HOLE DIAMETER	MAX CURRENT
CTSN431/12W	8mm/20A	No	3.2mm	4.0mm <sup>2</sup> /12AWG	M3	94mm	18mm	15mm	8mm	2.8mm	32A
CTSN431/12	8mm/15A	Yes	3.2mm	2.5mm <sup>2</sup> /14AWG	M3	94mm	18mm	15mm	8mm	2.8mm	32A
CTSN433/12W	10mm/30A	No	3.5mm	6.0mm <sup>2</sup> /10AWG	M3	116mm	21mm	16mm	9.95mm	2.8mm	41A
CTSN433/12	10mm/20A	Yes	3.5mm	4.0mm <sup>2</sup> /12AWG	M3	116mm	21mm	16mm	9.95mm	2.8mm	41A
CTSN434/12W	12mm/50A	No	4.4mm	10.0mm <sup>2</sup> /8AWG	M3.5	140mm	23mm	18mm	12mm	2.8mm	57A
CTSN434/12	12mm/30A	Yes	4.4mm	6.0mm <sup>2</sup> /10AWG	M3.5	140mm	23mm	18mm	12mm	2.8mm	57A
CTSN436/12W	13.5mm/65A	No	6.0mm	16.0mm <sup>2</sup> /6AWG	M4	159mm	26mm	22.5mm	13.5mm	3.6mm	76A
CTSN436/12	13.5mm/65A	Yes	6.0mm	10.0mm <sup>2</sup> /8AWG	M4	159mm	26mm	22.5mm	13.5mm	3.6mm	76A
CTSN438/12W	18mm/85A	No	7.5mm	25.0mm <sup>2</sup> /4AWG	M5	205mm	36.5mm	30.5mm	17.4mm	3.4mm	101A

### Raised Base

TYPE NO.	PITCH / UL RATING	WIRE PROTECTION	INSERT DIAMETER	CABLE ACCEPTANCE	TERMINAL SCREWS	LENGTH	WIDTH	HEIGHT	PITCH	FIXING HOLE DIAMETER	MAX CURRENT
CTSN431/12WR	8mm/20A	No	3.2mm	4.0mm <sup>2</sup> /12AWG	M3	94mm	18mm	17mm	8mm	2.8mm	32A
CTSN431/12R	8mm/20A	Yes	3.2mm	2.5mm <sup>2</sup> /14AWG	M3	94mm	18mm	17mm	8mm	2.8mm	32A
CTSN433/12WR	10mm/30A	No	3.5mm	6.0mm <sup>2</sup> /10AWG	M3	116mm	21mm	17.5mm	10mm	2.8mm	41A
CTSN433/12R	10mm/30A	Yes	3.5mm	4.0mm <sup>2</sup> /12AWG	M3	116mm	21mm	17.5mm	10mm	2.8mm	41A
CTSN434/12WR	12mm/50A	No	4.4mm	10.0mm <sup>2</sup> /8AWG	M3.5	140mm	23mm	20mm	12mm	2.8mm	57A
CTSN434/12R	12mm/50A	Yes	4.4mm	6.0mm <sup>2</sup> /10AWG	M3.5	140mm	23mm	20mm	12mm	2.8mm	57A
CTSN436/12WR	13.5mm/65A	No	6.0mm	16.0mm <sup>2</sup> /6AWG	M4	159mm	26mm	26mm	14mm	3.6mm	76A
CTSN436/12R	13.5mm/65A	Yes	6.0mm	10.0mm <sup>2</sup> /8AWG	M4	159mm	26mm	26mm	14mm	3.6mm	76A

### Alternative Options

TYPE NO.	PITCH / UL RATING	WIRE PROTECTION	INSERT DIAMETER	CABLE ACCEPTANCE	TERMINAL SCREWS	LENGTH	WIDTH	HEIGHT	PITCH	FIXING HOLE DIAMETER	MAX CURRENT
CTSN433/12WL	10mm/30A	No	3.5mm	6.0mm <sup>2</sup> /10AWG	M3	116mm	31mm	16.8mm	10mm	2.8mm	41A
CTSN433/12L	10mm/30A	Yes	3.5mm	4.0mm <sup>2</sup> /12AWG	M3	116mm	31mm	16.8mm	10mm	2.8mm	41A
CTSN433/12WLC	10mm/30A	No	3.5mm	6.0mm <sup>2</sup> /10AWG	M3	116mm	31mm	21.5mm	10mm	2.8mm	41A
CTSN433/12LC	10mm/30A	Yes	3.5mm	4.0mm <sup>2</sup> /12AWG	M3	116mm	21mm	17.6mm	9.95mm	3.6mm	41A
CTSN433/12WS	10mm/30A	No	3.5mm	6.0mm <sup>2</sup> /10AWG	M3	116mm	21mm	17.3mm	10mm pin	3.5mm	41A
CTSN433/12S	10mm/30A	Yes	3.5mm	4.0mm <sup>2</sup> /12AWG	M3	116mm	21mm	17.3mm	10mm pin	3.5mm	41A
CTSN433/12WQ	10mm/30A	No	3.5mm	6.0mm <sup>2</sup> /10AWG	M3	116mm	21mm	18.1mm	9.95mm	2.8mm	41A
CTSN433/12Q	10mm/30A	Yes	3.5mm	4.0mm <sup>2</sup> /12AWG	M3	116mm	21mm	18.1mm	9.95mm	2.8mm	41A

# INTERCONNECTION

Standard type, no wire protection

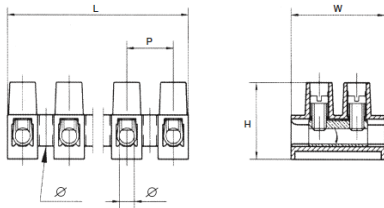

Raised base types - provides increased isolation

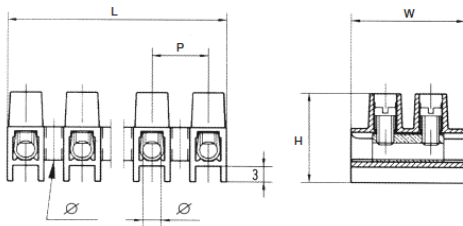

CTSN433/12LC larger isolating surface per pole and screw tower.  
Complies with EN60598/1 4.7 and 11.2

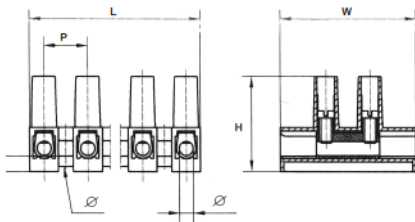

CTSN433/12L larger isolating surface per pole (750V, test voltage 3,000V)  
Complies with EN60598/1 4.7 and 11.2

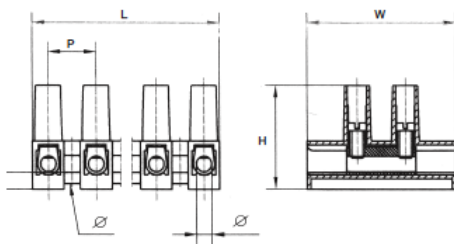

CTSN433/12T fast fixing hole between poles

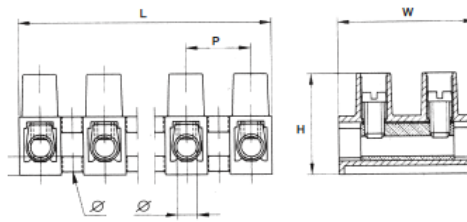

CTSN433/12TR fast fixing hole between poles and raised base

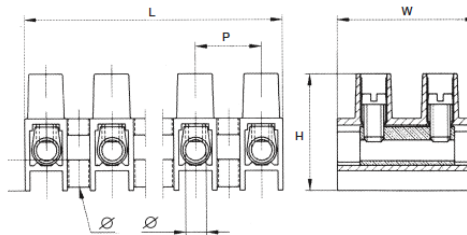

CTSN433/12TRG fast fixing hole between poles, raised base and socket in the base

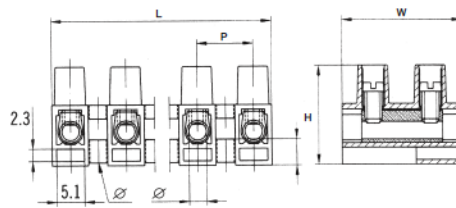

CTSN433/12S fixing pin

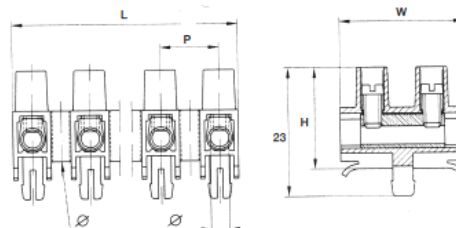

CTSN433/12Q fixing hole between poles and wide base terminal connection

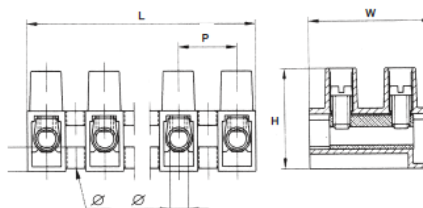

PCB  
TERMINAL  
BLOCKS

INTER-  
CONNECTION

FUSES &  
FUSE-  
HOLDERS

LEDs &  
INDICATORS

MINIATURE  
SWITCHES

LIMIT &  
SAFETY  
SWITCHES

CONTROL  
PRODUCTS

INTERFACE  
MODULES &  
SUPPORTS

RELAY  
BASES

ENCLOSURES

BATTERIES

TRANS-  
FORMERS